

INSIDE/OUTSIDE

# OFFICE

DESIGN V 办公室设计V

深圳市艺力文化发展有限公司 编



华南理工大学出版社  
SOUTH CHINA UNIVERSITY OF TECHNOLOGY PRESS

·广州·

## 002 | ADVERTISING/MARKETING

- 002 Velti Headquarters  
Velti 总部
- 008 Innocean Headquarters Europe  
Innocean 欧洲总部
- 016 BBDO Group Advertising Agency Moscow  
Representative Office  
BBDO 广告集团莫斯科代表处

## 024 | ARCHITECTURE FIRM

- 024 Astarta's Moscow Office  
阿斯塔塔莫斯科办公室
- 030 Office Design of IND Architects  
IND Architects 工作室

## 038 | FINANCIAL/BUSINESS SERVICES

- 038 HSB  
HSB 办公空间
- 050 Alfa Bank Office  
阿尔法银行办公室
- 062 The Gores Group Headquarters  
格雷斯集团总部
- 074 Co-Work Angel Office  
Co-Work Angel 办公室
- 082 Algomi  
Algomi 办公空间
- 090 ZS Associates  
致盛咨询公司办公室

## 102 | FOOD/BEVERAGE

- 102 Red Bull - Cape Town Headquarters  
红牛开普敦总部
- 112 Head Offices, Red Bull Canada  
加拿大红牛总部
- 120 Coca-Cola London Headquarters  
可口可乐伦敦总部

## 126 | FURNITURE / PRODUCT

- 126 One Workplace Headquarters  
One Workplace 总部
- 138 PETZL North American Headquarters and  
Distribution Center  
PETZL 北美总部和配销中心
- 146 American Standard  
美标办公室

## 156 | GAMING

- 156 Chartboost San Francisco Office  
Chartboost 旧金山办公室
- 162 Lego Turkey  
土耳其乐高办公空间

## 166 | HARDWARE / SOFTWARE DEVELOPMENT

- 166 Microsoft Gurgaon  
吉尔冈微软办公室
- 182 Microsoft - Redmond Building 44 Offices  
微软公司——雷德蒙 44 号办公楼
- 190 Meltwater Tenant Improvement  
融文集团办公室
- 196 Autodesk Israel - Tel Aviv  
以色列特拉维夫市欧特克开发中心
- 204 Headquarter of Microsoft in Lisbon  
里斯本微软总部

## 216 | MANUFACTURING

- 216 Unilever Brand Hub Europe  
联合利华欧洲品牌中心
- 226 NUON Amsterdam  
阿姆斯特丹 NUON 总部
- 236 Unilever Algida Ice Cream Factory  
联合利华 Algida 冰激凌工厂

## 242 | MEDIA / PUBLISHING

- 242 BBC Worldwide Americas  
英国广播公司美洲总部
- 250 MTV Networks Headquarters  
音乐电视网总部
- 258 Wunderman/Bienalto Sydney  
悉尼 Wunderman 和 Bienalto 公司办公室

## 266 | MISCELLANEOUS

- 266 'T PARK  
T 公园办公空间
- 272 Integral Iluminación Comercial Building  
Integral Iluminación 商业大楼
- 280 EMKE Office Building  
EMKE 办公大楼
- 286 Mi9 Sydney  
Mi9 悉尼办公室
- 296 Uniform  
Uniform 办公空间
- 304 Grupo CP Corporate Interior  
Grupo CP 公司办公室
- 320 Silos 13  
13 号筒仓
- 328 Talent Garden office, Brescia - Italy  
意大利布雷西亚 Talent Garden 办公室
- 336 Johnson & Johnson Eyesight Health Institute  
强生视力健康研究所
- 344 EB Group Showroom & Office  
EB 集团展厅和办公室

## 352 | NON-PROFIT/GOVERNMENT

- 352 Headquarters of the Fondation Jérôme  
Pathé Seydoux  
百代基金会总部
- 362 NS Stations  
NS Stations 办公室
- 372 Northern Territory  
泰利驿站

## 380 | SOCIAL/WEB/ONLINE

- 380 Google Amsterdam  
阿姆斯特丹谷歌办公室
- 386 Walmart Headquarter in São Paulo  
圣保罗沃尔玛总部
- 400 Tencent Guangzhou Office  
腾讯广州办公园区
- 410 Contributors  
设计师名录



# NUON Amsterdam

阿姆斯特丹 NUON 总部

Architects: Heyligers design+projects

Area: 27,000 m<sup>2</sup>

Photography: Rick Geenjaar

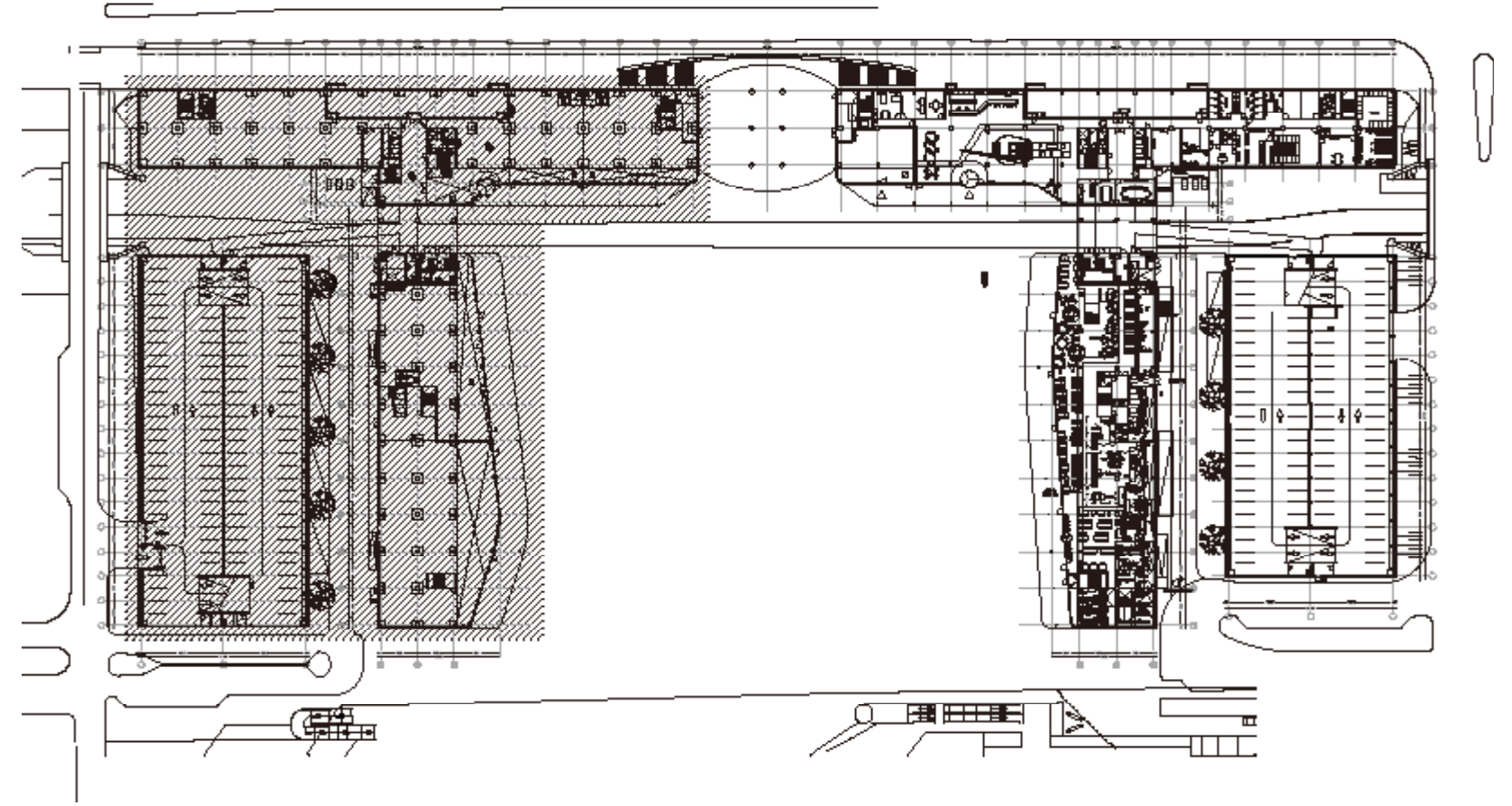

27,000 m<sup>2</sup> sustainable reuse and regeneration for "the new way of working" in Amsterdam Southeast.

The "nieuwAmsterdam" building was built 25 years ago and recently completely transformed into a modern mixed-use building with hotel, catering industry and 27,000 m<sup>2</sup> of office space for power company NUON.

In September of 2012, HEYLIGERS d+p was awarded the contract to provide the interior design for NUON and only 15 months later the new office was taken into use. With its new head office NUON embraced "the new way of working", work shifting: a fully open and flexible working environment.

The interior design consists of open work floors that are focused on diverse and flexible working by being interspersed with conference rooms, telephone booths, concentration workplaces, pantry's, "executive suites" and project rooms. The building offers diverse facilities for its users, including a reception lobby with a water bar, a restaurant with 650 seats, a library, an espresso bar, a service centre, a conference centre, and a sky lounge.

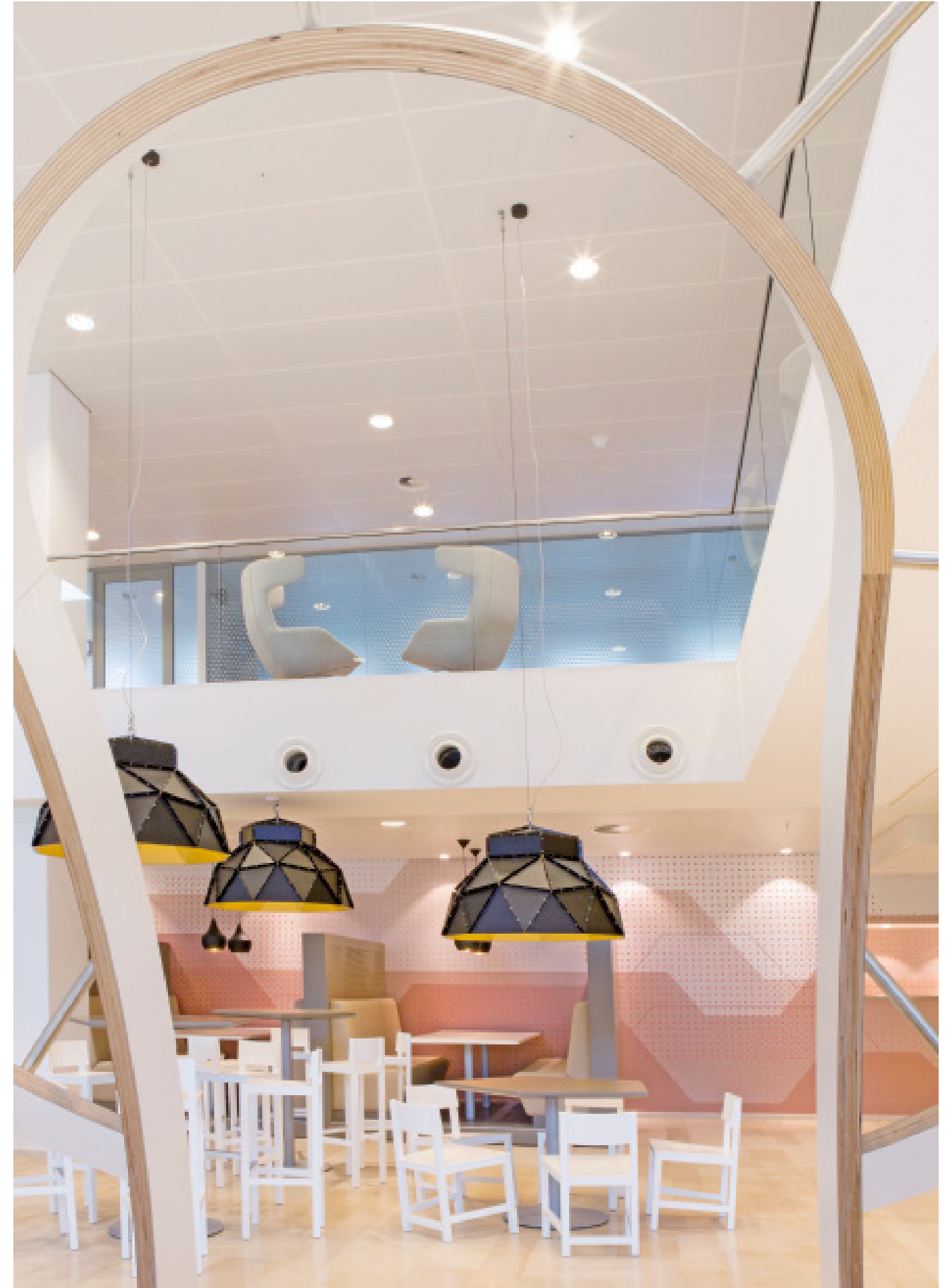

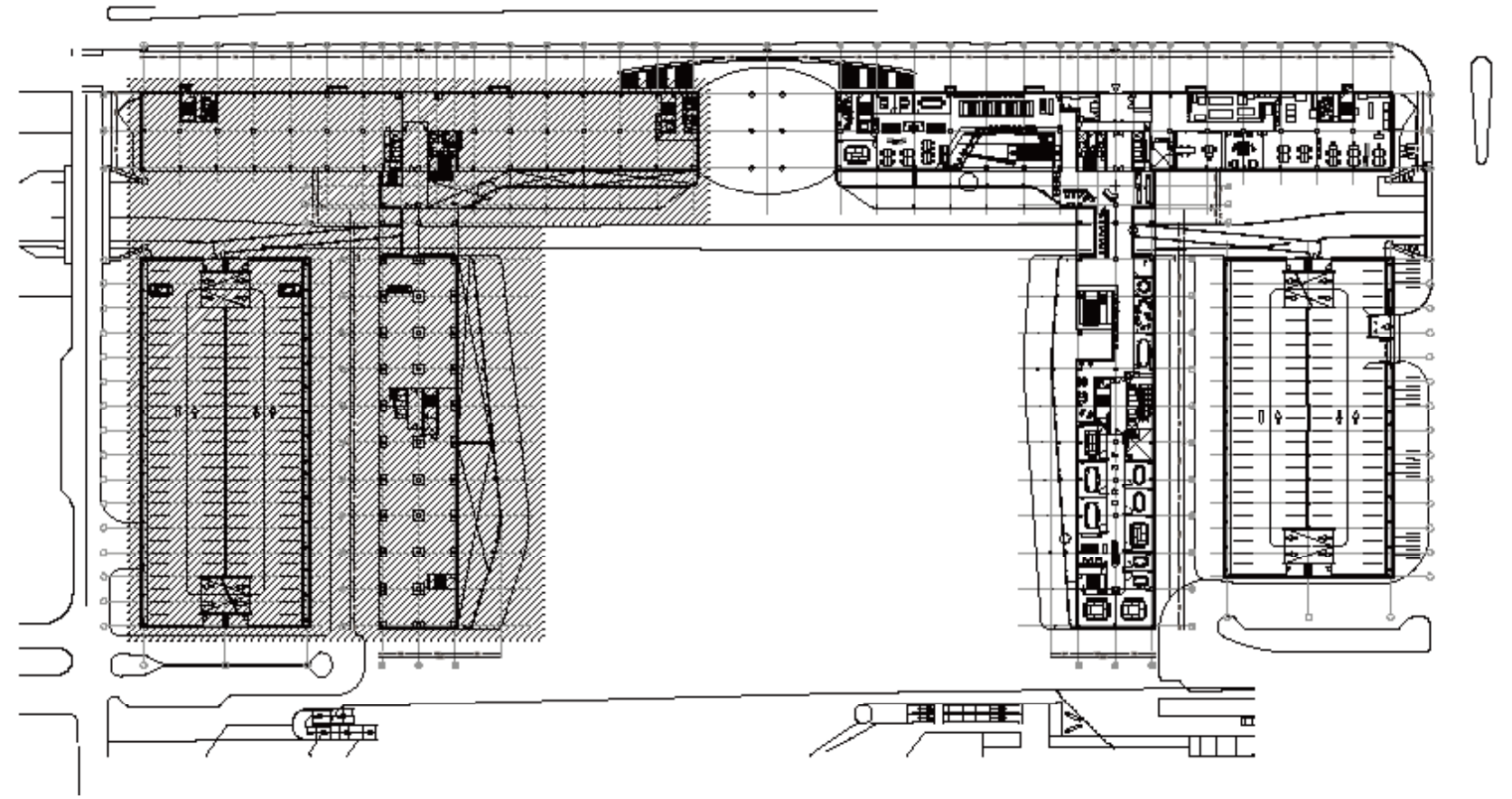





The 27,000 m<sup>2</sup> is spread over 6 floors. To create diversity and orientation in the long building the NUON Energy Sources were taken as a starting point in the interior design. These 6 sources were each translated into their own section design through the assignment of colour, material, photo prints and glass foils. This way, each of the building's "neighbourhoods" has their own specific identity, and a clear location within "nieuwAmsterdam".

With its renovation, the building has been certified "BREEAM Very Good". To

这个阿姆斯特丹东南部的项目通过可持续地再利用 27 000m<sup>2</sup> 的空间，重建了一种“新工作方式”。

这栋“nieuwAmsterdam”建筑建于 25 年前，最近转型成现代混合使用建筑，包括宾馆、餐饮业和 NUON 电力公司的 27 000m<sup>2</sup> 办公空间。

2012 年 9 月，HEYLIGERS d+p 建筑设计机构接受了为 NUON 设计室内空间的合同，在短短的 15 个月后，新办公室便投入了使用。新总部适应了“新工作方式”，移动办公；完全开放、极其灵活的办公环境。

achieve this sustainability class, points were scored both on the exterior and the interior design. The latter is remarkable because BREEAM has not yet been adapted to new workplace concepts, which means that the interior design has to meet high demands to be able to achieve this score.

The architectural renovation has been realized by the Architecten Cie, and led by Bramir Medic.

室内设计了开放办公楼层，设置了多样灵活的办公空间，此外还穿插了会议室、电话间、单人工作区、食品室、“行政套房”和项目策划室。建筑为使用者提供了多样化的设施，包括接待大厅（带有水吧）、餐厅（可容纳 650 人）、图书馆、浓咖啡吧、服务中心、会议中心以及空中酒廊。

项目设计包括 6 层，总面积为 27 000m<sup>2</sup>。为了让这栋长条形建筑内的空间更加多样化，导向性更加明确，NUON 能源公司便成了室内设计的出发点。通过使用不同的色彩、材料、图案和玻璃，6 种能源都被充分诠释到了各自的分区中，从而让建

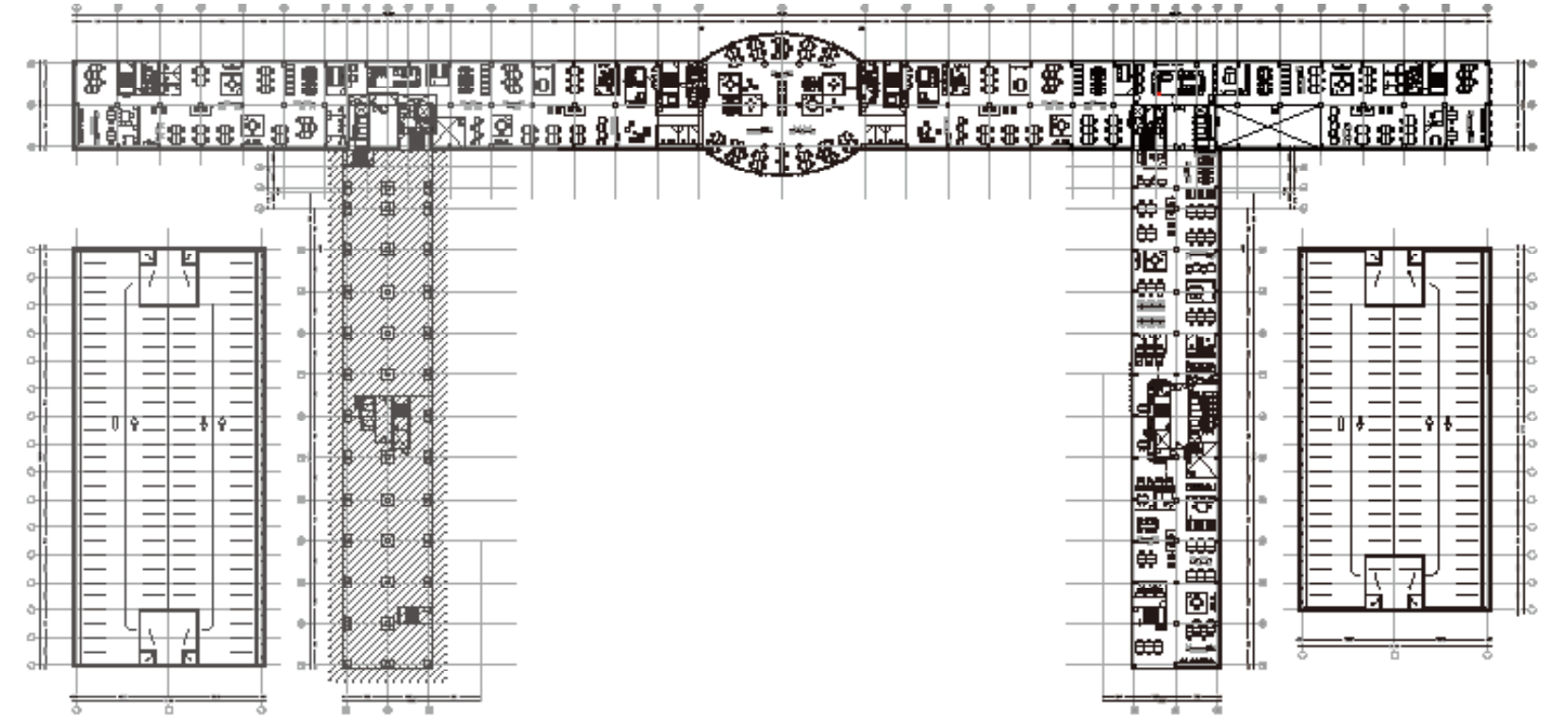

筑的每个“邻域”具有自身的特点，在“nieuwAmsterdam”建筑中的位置也十分明确。

建筑经过翻新之后，被评为三星级英国绿色建筑（BREEAM Very Good）。还对建筑的内外设计进行了评估，来确定建筑的可持续发展类别。后者更加有说服力，

因为当时英国绿色建筑评估体系（BREEAM）还未应用到新办公空间理念上来，这就意味着室内设计必须满足很高的要求，才能获得这种评价。

建筑翻新项目是在 Bramir Medic 的指导下，由 Architecten Cie 完成的。





its stage, building a formidable reputation for award-winning designs, and an adherence and expertise in 'green' sensibility.

This promise of excellence has drawn a marquee clientele that includes multinational organisations, leading developers of the country, world class hotel franchises, leading business houses and many more.

DSP's mission is to bring an unusual degree of quality, reliability, and refinement to the table and provide a personalized & total quality effort focusing our ability to deliver exceptional service to exceed Clients expectations.

## Estudio Guto Requena

Estudio Guto Requena reflects about memory, digital culture and poetic narratives in all design scales. Guto, 34 years old, was born in Sorocaba, countryside of Sao Paulo State. He graduated as Architect and Urban Planner in 2003 at USP - University of São Paulo. During nine years he was a researcher at NOMADS.USP - Center for Interactive Living Studies of the University of São Paulo. In 2007 he got his Master degree at the same University with the dissertation, Hybrid Habitation: Interactivity and Experience in the Cyberculture Era.

He won awards and had lectured and exhibited in several countries. He was a professor at Panamericana - School of Arts and Design and at IED - Istituto Europeo di Design - at both graduation and master levels. Guto had lectured on 70 workshops all over the country, and received the Young Brazilian Awards recognition. In 2012 Guto was selected by Google to develop the project for their Brazilian headquarter. And in 2013 Walmart selected him to design their headquarter.

Since 2012 Guto has a column at newspaper Folha de São Paulo where he writes about design, architecture and urbanism and collaborates writing for many magazines. In 2011 Guto created, wrote and hosted the TV show Nos Trinques, for Brazilian TV Globo channel GNT and developed design web series for the same channel, recorded in Milan, Paris, Amsterdam and London.

## Fokkema & Partners Architecten

Fokkema & Partners Architecten is often asked to describe the firm's chief characteristics. Just naming a single style doesn't serve to answer this question, since the projects vary so widely. Still, since the start of the firm in 1995 all projects have had one thing in common: a drive for quality that exceeds their clients' expectations. It's our ambition to get the most out of a design question on their clients' behalf - a thorough process that starts in understanding clients needs through carefully and methodically trying to come to the core of the matter.

Fokkema & Partners Architecten encourage clients to come up with considerations and critical questions during the concept development phase. They fee that concept development really is one of the most important phases of the design process, a stage with a clear moment, when the true nature of the solution is determined. It is a phase when out of the box thinking, sharp analysis and down to earth practicality all come together in their effort to constantly raise the bar and stay away from the obvious.

During the next phase of design development we keep utilizing their creative capacities to find solutions which stay away from the obvious but still remain practical. At the end of the day they like to be inspired and have fun, but most importantly they want our client to be proud of their common result.

## Giant Leap

Whatever your business, you want to create spaces that inspire people. Giant Leap is passionate about designing superior interiors that take you on a journey the minute you step inside. We share a passion for excellence in design, delivery, and finish, always using the finest materials, technology, logistics and people. We create better places to work, rest, play, be original, be comfortable, and above all, be inspired. This is the heart of Giant Leap.

## HEYLIGERS design+projects

HEYLIGERS design+projects is an agency for interior design and architecture with approximately 15 to 25 employees in two offices in Amsterdam and Utrecht. In its 25- year existence, the agency has established itself as a specialist in the design and management of complex and innovative interior design commissions for the business market t in the Netherlands and abroad. The research and implementation of new workplace concepts is often part of the scope. In all projects we aim towards an end result that holds the maximum achievable sustainability qualification. HEYLIGERS design+projects has broad experience in achieving LEED, BREEAM and Greencalc + certification.

## IND Architects Studio

IND Architects Studio is featured by a particular attention to details. They believe that it is a detail that shows the quality of architecture.

Their team consists of experienced architects who develop the projects starting with a sketch and following it up to complete implementation of intended ideas.

They are united by true passion and commitment.

Since the studio was founded in 2008, they have been dealing with design of apartment and public buildings, town houses and interiors, office premises, hotels, business-centers and restaurants. In these latter days, they are engaged in development of landscape and urban design areas and widely participate in various competitions.

Their strengths: individual attention to every client, effective system of business processes, flexible and quick decision-making, complex approach to architecture and interior, thorough researches and quality analysis at all project phases, quick adaptability to new market requirements.

They provide their clients with comprehensive design documents prepared in accordance to high standards.

Their clients are comprised of those who generate the demand for high-quality architecture: individuals, state officials, businessmen, development corporations.

You can find their works in the most picturesque places of Russia, Spain, Montenegro and Kazakhstan. They are keen to expand this list and take part in up-market international contests.

## Ippolito Fleitz Group

Ippolito Fleitz Group is a multidisciplinary, internationally operating design studio based in Stuttgart. Currently, Ippolito Fleitz Group presents itself as a creative unit of 45 designers, covering a wide field of design, from strategy to architecture, interiors, products, graphics and landscape architecture, each contributing specific skills to the alternating, project-oriented team formations. Their projects have won over 200 renowned international and national awards.

## Jannina Cabal & Arquitectos

Jannina Cabal Arquitectos Studio was founded in 2003 after 4 years of work and experience in construction companies and architectural consulting firms. Since the beginning, the acceptance received by private clients and real estate developers was outstanding, generating a positive commercial growth to the studio. JCA presented a very clear and defined design style, recognized by clients who arrived seeking for innovative proposals. This happened within a competitive and complicated field that thanks to the work of young architects full of creativity and energy. Therefore, they had to deal with many new challenges that demanded a lot of effort, dedication and progressive work.

Today, the studio has a team of 10 architects, specialized in several areas, in addition to the group of consulting engineers that collaborate with JCA.

In the present the firm is involved in a variety of successful residential, urban and commercial projects within Ecuador.

## Johnson Chou Inc.

Since 1999, Johnson Chou Inc. has developed into an interdisciplinary design practice encompassing architectural and industrial design, furniture and interiors, graphic identity and corporate communications - a body of work characterized by conceptual explorations of narrative, transformation and multiplicity.

While the search for the elemental is the defining aspect of their work, elements of drama and engagement - on intellectual, emotional and physiological levels of experience - exemplify the firm's projects.

The creation of a narrative forms the conceptual point of departure for all of the firm's work and is essentially a story inspired by the client. Be it about the quirks of the client, an image they wish to project, or even delved from a literary source, it is an interpretation of the client's image, culture or brand - what the firm likes to describe as "narratives of inhabitation".

The firm's award-winning and internationally recognized projects include advertising offices for Grip Limited and Zulu Alpha Kilo, Head Offices for Red Bull Canada and private residences in 10 Bellair and the Candy Factory condominiums. Other projects include the Museum of Canadian Contemporary Art (MoCCA), TNT and 119 Corbo clothing boutiques, and Blowfish Restaurants.

## LAB5 architects

LAB5 architects is a Budapest (EU) based design studio established in 2007, covering full services for urban, architectural, and interior design. The company provides characteristic solutions, where the iconic look-out is combined with pragmatical functional layout, usually on European and Asian sites.

## Li Yiming

Li Yiming First grade registered architect Senior Engineer Design Director, Beijing Qingshi Architectural Design and Consulting Co., Ltd.

He graduated from Northern Jiaotong University in 1998, majoring in Civil and Structural Engineering. Since graduation, he has been engaged in architectural solutions and managing design projects in large state-owned design institution. He has worked on over 20 large projects one and after

another, covering urban mixed-use project, commercial center, five-star hotel and large-scale science and technology park, etc.

Representative works include Zhongguancun Dongsheng Science and Technology Park, Taishun Cultural and Creative Industrial Park, Beijing Four Seasons Creative Park, Beijing Union University Zhongguancun City of Science, Art Center of Capital Norman University, Xi'an Hua Qing Palace Yutang Spa & Resort Hotel, Ningxia Shapotou State Guest House, Yunnan Anxia Riverside Resort, etc.

## Lv Xiang

Lv Xiang Senior interior architect Technical Director, Beijing Qingshi Architectural Design and Consulting Co., Ltd. He graduated from Shandong Institute of Urban Construction in 1997. Since graduation, he has been engaged in interior design and project management, including large office, financial institution, high-end hotel, restaurant and suchlike hundreds of projects.

Representative projects include Bank of China Financial Center, Chengtong Group Headquarters, Management Committee Center Building of Chengdu Hi-tech District, Beijing Shijingshan District Court, Beijing Century Technology and Trade Building, Beijing Dong An Men Hotel, Beijing Gloria Plaza Hotel Dongsheng, Dalian Bangchui Island Resort Hotel, Sichuan Zigong Grand Hotel, etc.

## MoreySmith

MoreySmith is an architectural design practice based in London. Founded in 1993 by Linda Morey Smith, the practice has an extensive portfolio of commercial, workplace, development, leisure and residential projects. The company mission is to deliver beautifully designed projects which reflect and embody the client, their brand ethos and needs. Projects are undertaken by employing a strategic approach underpinned with design-led and detail-focused thinking.

The practice offers architectural design, interior and exterior refurbishment, interior design, branding and property services. MoreySmith works with both occupiers and developers. MoreySmith is passionate about designing environments where people love to work.

## M Moser Associates

M Moser Associates is a global firm specialising in the architecture, engineering, interior design, and delivery of corporate workplaces. Clients range from multinational companies and financial institutions to privately-owned businesses.

A key to how M Moser fulfils clients' business needs is the Integrated Project Delivery (IPD) approach. This enables project teams and services to be precisely focused on the unique demands of each client and project. IPD also enables spaces and buildings to be developed and delivered as truly holistic solutions to clients' specific needs.

M Moser's 700+ staff includes experienced planners, interior designers, architects, engineers, IT specialists and construction professionals. Founded in 1981 - and in 15 locations worldwide - the company currently operates in Bangalore, Chengdu, Beijing, Delhi, Guangzhou, Hong Kong, Kuala Lumpur, London, Mumbai, New York, San Francisco, Shanghai, Shenzhen, Singapore and Taipei.